

Peterbilt 337-348-382 PeopleNet Connected Gateway™ Install

Install Steps



- 1) Connect and mount the display.
- 2) Connect and mount the PCG.
- 3) Connect the display blue barrel and 2-pin power to the PCG Main Cable. Non-Trimble displays will not require the blue barrel.
- 4) Connect the PCG Main Cable to the vehicle (On-Dash Install) or Y-Cable (In-Dash Install).
- 5) Connect the Y-Cable to the vehicle (In-Dash Install).

Install Overview



On-Dash Installation Steps

- 1) Connect the PCG Main Cable to the vehicle diagnostic port.
- 2) Route the PCG cable up the side of the dash, making sure it is clear of the door.
- 3) Clean a spot on top of the dash using an alcohol swab and a paper towel, then attach the PCG using the tape provided.
- 4) Mount the display-See below for options and steps.
- 5) Route the display cable to the connectors on the PCG cable, then connect both the 2-pin power and blue barrel connections.
- 6) Bundle the cables so they cannot interfere with the safe operation of the vehicle.
- 7) Turn the vehicle key ON to boot the system, then follow the PCG Activation steps.

In-Dash Installation Steps

- 1) Connect the PCG Main Cable to the Y cable and connect the Y cable to vehicle, leaving the Y-cable male as the new vehicle diagnostic.
- 2) Route the PCG cable through the dash to the mount location shown below.
- 3) Clean the PCG mounting space using an alcohol swab and a paper towel, then attach the PCG using the tape provided, making sure the logo is facing the sky.
- 4) Mount the display-See below for options and steps.
- 5) Route the display cable to the connectors on the PCG cable, then connect both the 2-pin power and blue barrel connections.
- 6) Bundle the cables so they cannot interfere with the safe operation of the vehicle.
- 7) Turn the vehicle key ON to boot the system, then follow the PCG Activation steps.

Display Mount

Mount the RAM base above the glove-box using bolts and a backing plate or large washers. If a longer swivel arm is preferred, RAM mount 101U-D is recommended. This is available through [RAM Mounts](#).

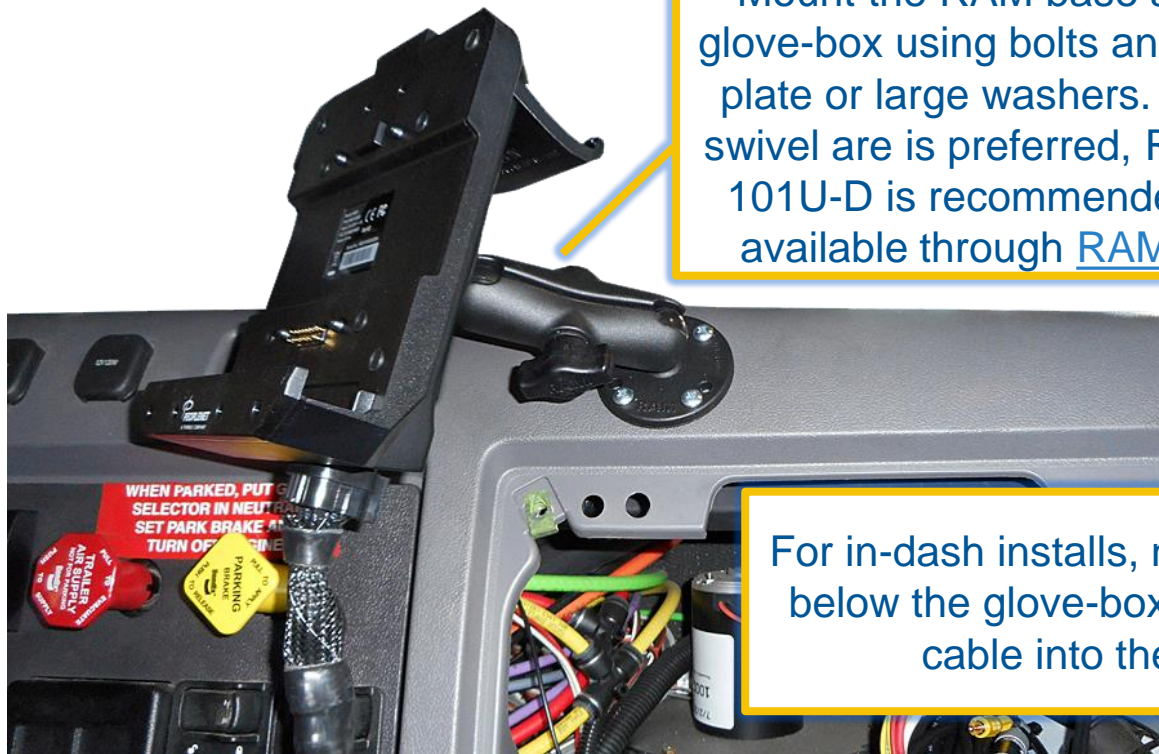

For in-dash installs, notch the panel below the glove-box and pass the cable into the dash.



Diagnostic Connection – On-Dash



Tuck the cable between the dash and cab side.

Connect the PCG Main Cable to the diagnostic connector.
This will work whether the diagnostic is black or green.

PCG Mount – On-Dash

Clean the top-center of the dash using alcohol and a clean paper towel.

Mount the PCG using the tape provided, then bundle and secure the cables.



Diagnostic Connection – In-Dash

Connect the vehicle connector to the green Y connector. This will work for both black and green diagnostic plugs.

Connect the PCG Main Cable to the green Y connector.

Mount the black male connector in place of the vehicle original.



PCG Mount – In-Dash

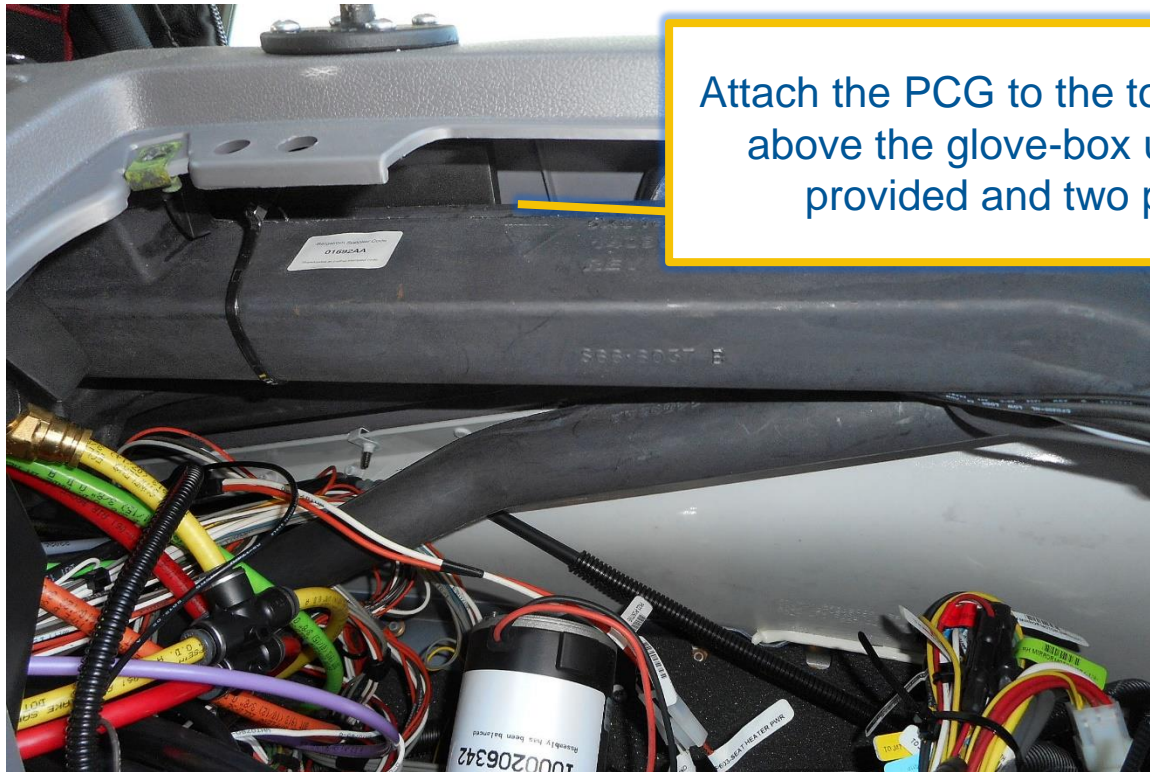

Attach the PCG to the top of the air-duct above the glove-box using the tape provided and two plastic ties.