

Isuzu PeopleNet Mobile Gateway[®] Standard Installation Guide

Install Overview

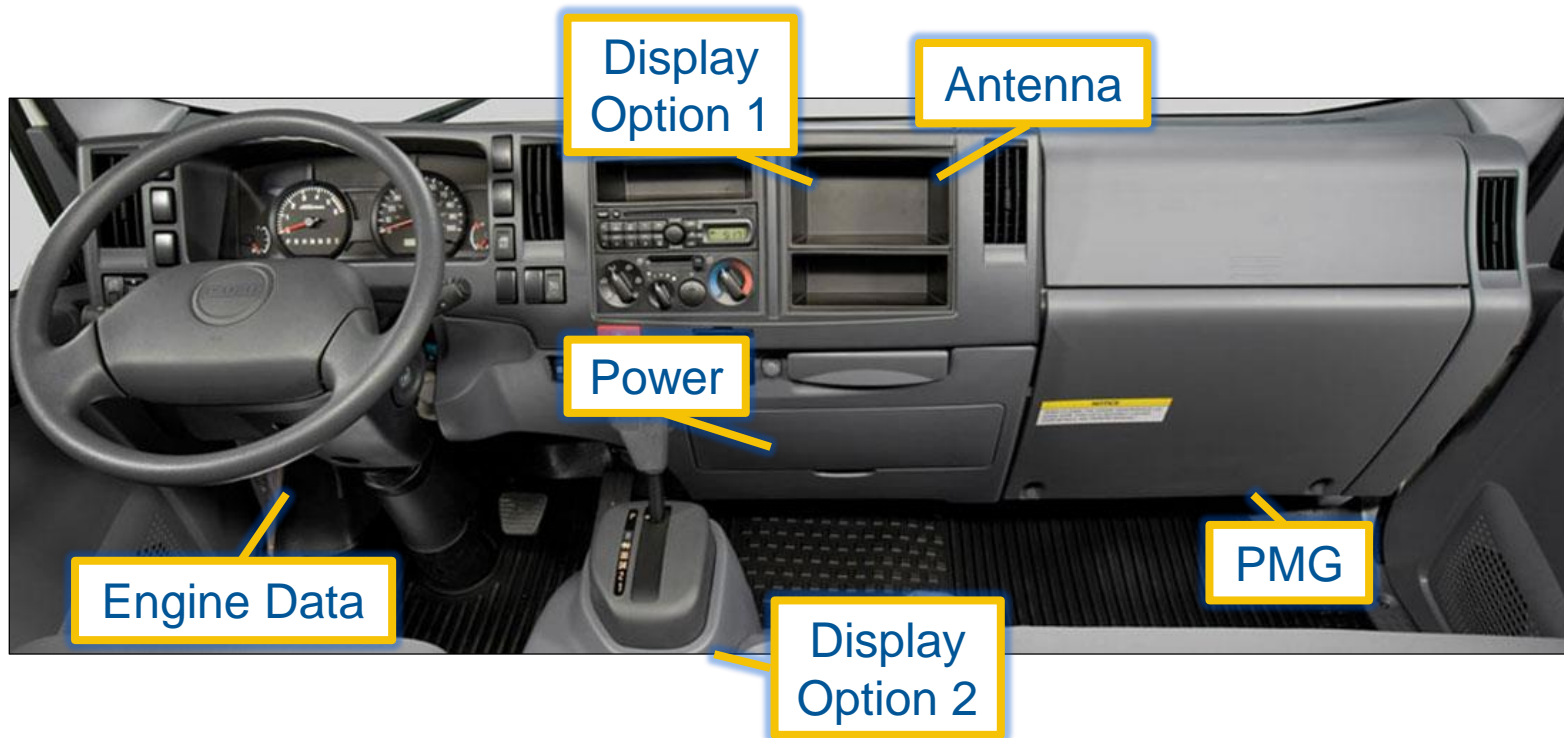

Non-Trimble Parts Recommendations

Isuzu installations can be done using only the standard parts, but a cleaner install requires purchase of a display mount and power connectors. Note that these are not Trimble parts.

RAM 10-inch Swivel Mount
RAM Part RAM-101U-D



This longer swivel gives the driver better access to the display regardless of which mount location is used.

<https://www.rammount.com/part/RAM-101U-D>

Mini-ATC Add-a-Circuit
(2 per vehicle)



These connectors are available from several online retailers and some auto parts stores. Search for “Mini-ATC Add-a-Circuit.”

Mini-ATC Add-a-Circuit Function

This diagram shows how power flows through the Add-a-Circuit connector. Always test the fuse position to make sure the vehicle input power is opposite the red lead.

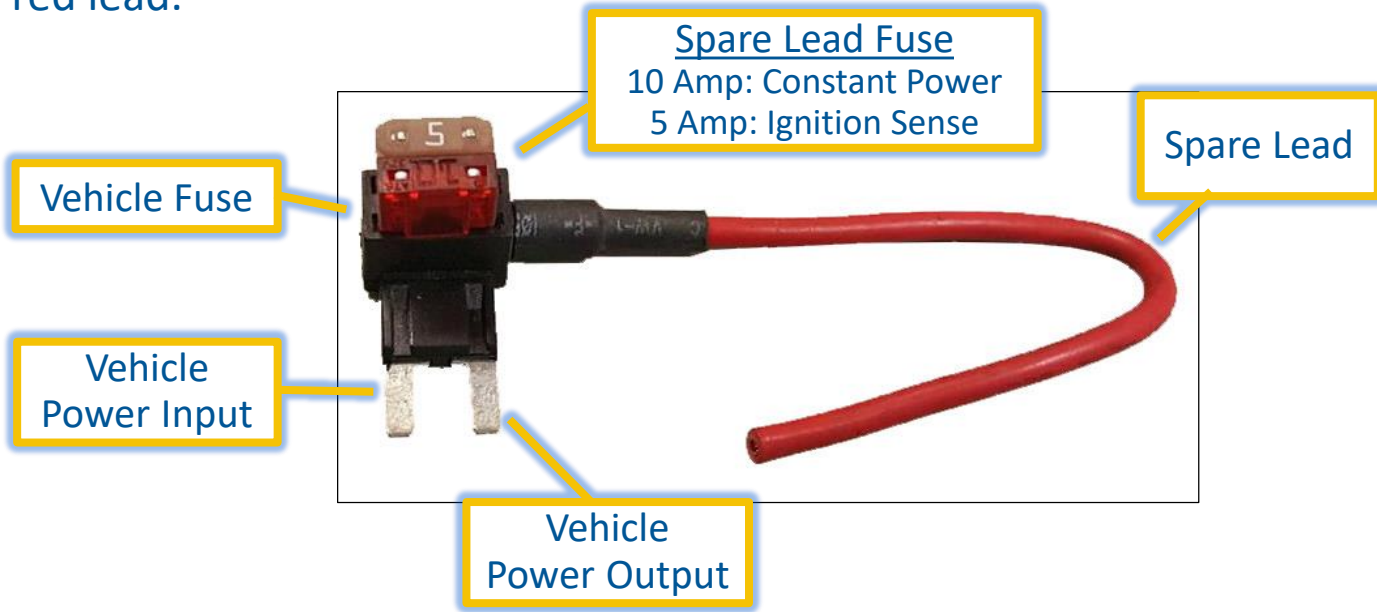

Power Connections

Fuse positions may vary by year. Check the fuse panel map for spare positions and verify the Constant Power is *always* powered and the Ignition Sense location is powered only when the key is **ON**, not when the key is off or in accessory.

RR P / WINDOW GLACE ELECT. AR.		ROOM LAMP, AUDIO PLAFONNIER, AUDIO	DOOR LOCK SERRURE DE PORTE	TRAILER BRAKE FREIN DE REMORQUE	P/W WIPER GLACE
1	2	3	4	5	6
25A		10A	15A	15A	25A
P.NO.898109 9890					
MIRROR HEATER CHAUFFAGE MIROIR	IGNITION2 ALLUMAGE2	IGNITION1 ALLUMAGE1		ECM MOD. COMM. ELECTRIQUE	METER
16	17	18	19	20	
15A	10A	10A		10A	

Constant Power
Blank Position 2

Ignition Sense
Blank Position 19

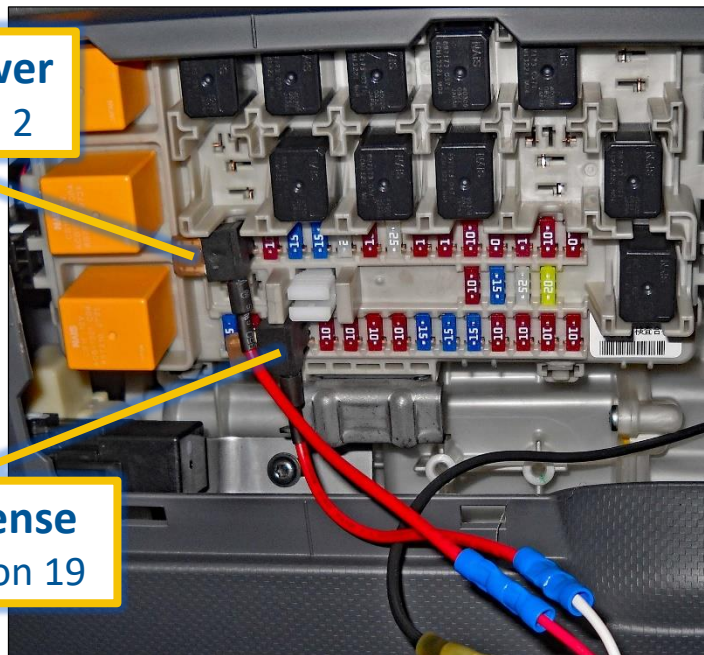

Ground Connection

The ground connection is screwed to the plate above the fuse panel area.

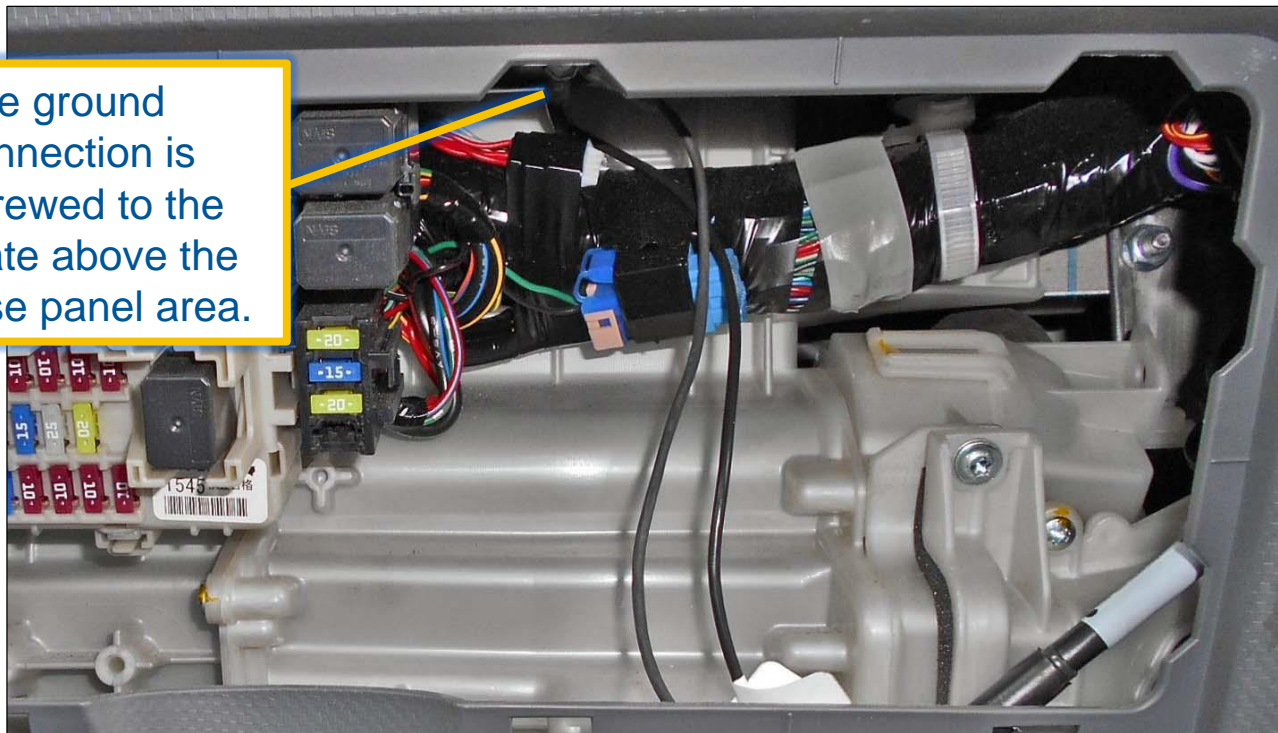

Engine Data

Remove the vehicle diagnostic port from its mount, connect it to the mate on the PMG OBDII cable, and tie it up inside the dash.

Secure the Trimble diagnostic port in place of the original and bundle the OBDII module and cables, making sure they cannot drop into the pedal area.

Route the cable across to the passenger's side, making sure to avoid moving parts.

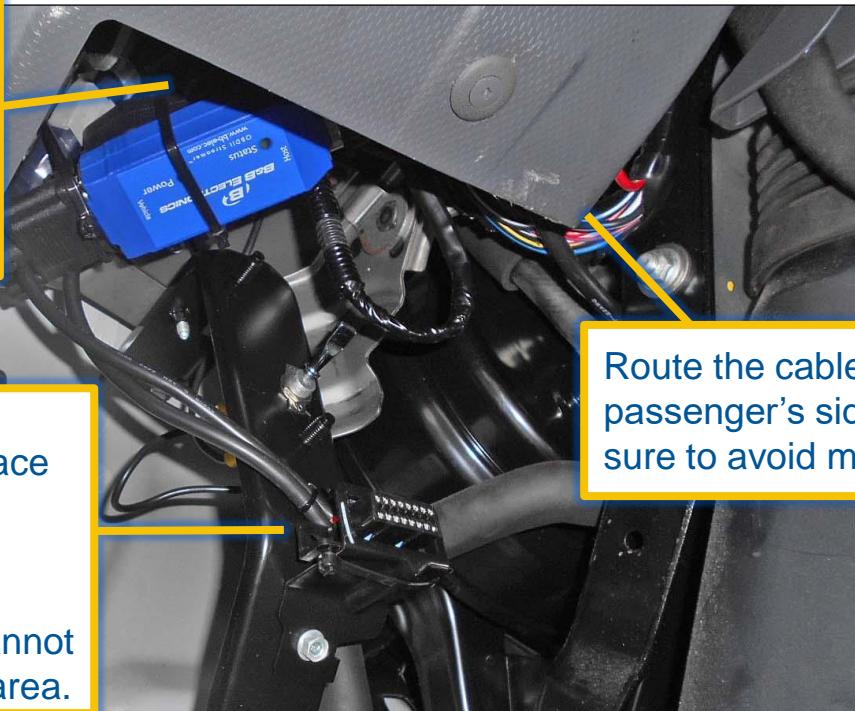

Antenna

Mount the antenna to the top of the dash duct, behind the central storage area, using the tape provided.

Bundle the coax and tie to the duct; then route the ends to the passenger's side.



Display Option 1

This mounting method puts the display in the driver's heads-up view.

Mount the RAM mount base to the inside of the large central dash storage space using a backing plate. The larger RAM is recommended, as it will give the driver better access to swivel.

Cut a 1-inch hole in the back of the storage space and route the display cables through.

Attach the display to the RAM mount and cable. Angle the display toward the driver and tighten the RAM.

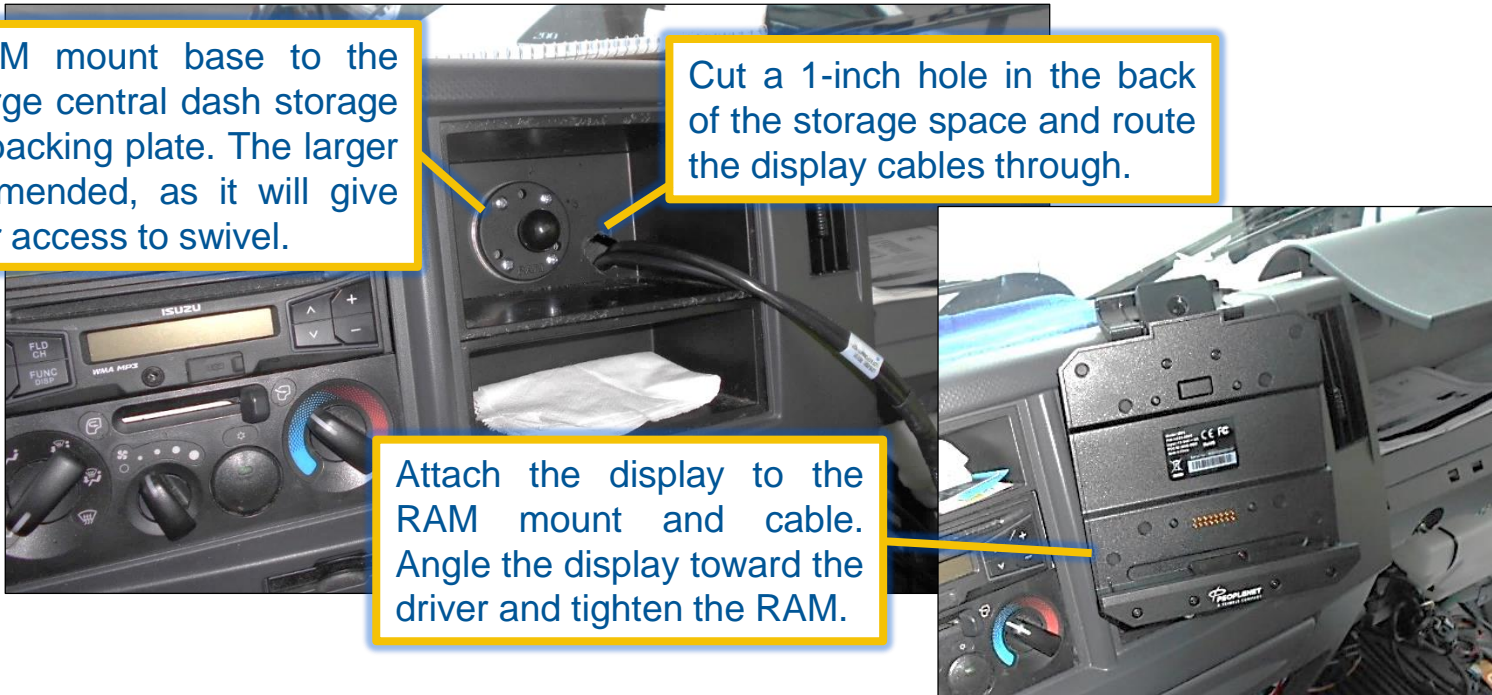

Display Option 2

This mounting method is simpler than Option 1 but leaves the display farther from the heads-up view.



Mount the RAM base to the engine cover using 4 screws. Always check first that the screws will not damage engine components.

Route the cable forward under the floor mat.

PMG Mount

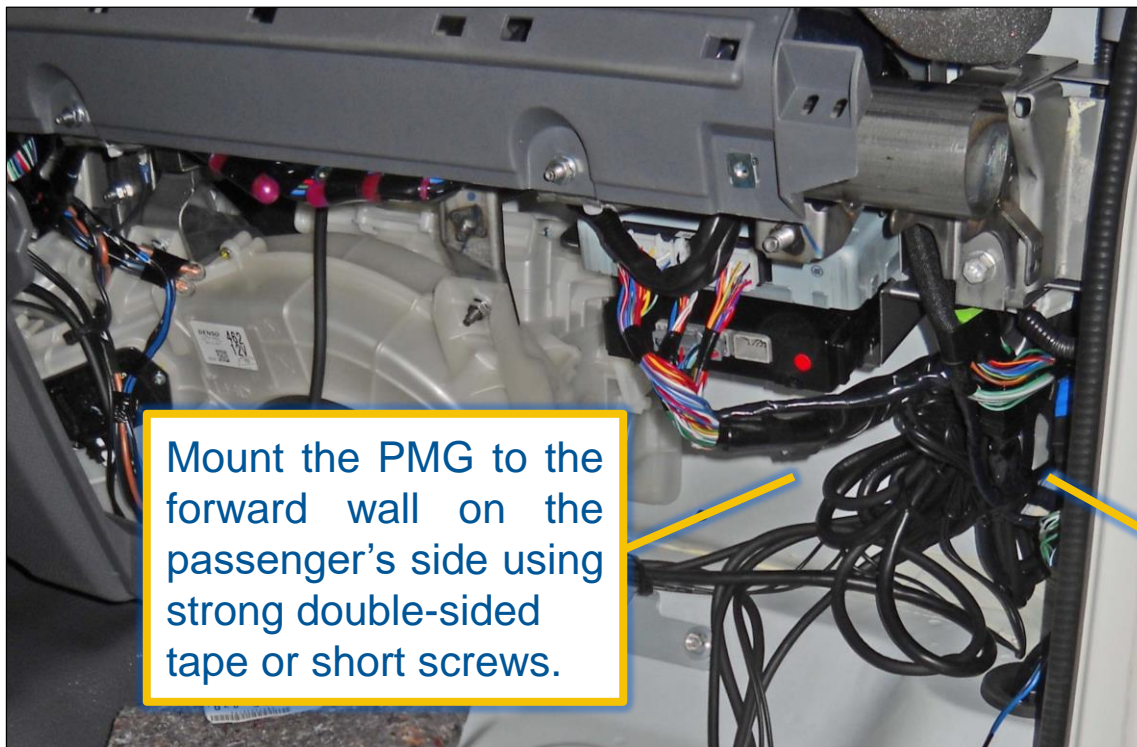

Mount the PMG to the forward wall on the passenger's side using strong double-sided tape or short screws.

Bundle any spare cabling to the braces at the A-pillar base.